

SAFETY

INCLEMENT WEATHER

Delayed Start

Delayed start will be called no later than 6:00am. A delayed start means that school will begin 2 hours later than normal at both the Elementary and Secondary campuses and that Pre-Kindergarten will be cancelled at the Elementary campus. On delayed-start days, Elementary students should arrive at the gym no earlier than 10:00am. After 3 Pre-K cancellations, the teacher will schedule make-up days.

Delayed Start on Wednesday (Chapel Day):

At the Elementary campus, if Chapel focus is a speaker, Chapel will be cancelled for that day. If Chapel focus is a class program (other than Pre-K), then Chapel will be held at 1:00pm that day. At the Secondary campus, the specific Chapel time will be determined at the beginning of each school year.

Shuttle Service on Delayed Start Days:

It may be in the best interest of ECA as a whole to hold school even when some of our surrounding school districts are having inclement weather. In these rare cases, we may cancel the shuttle service and still elect to hold school. The shuttle cancellations will likely be due to dangerous conditions for "high profile vehicles", like our bus and shuttle fleet. On these occasions, parents will be responsible to get their children to school if the conditions are safe enough for them to travel.

Cancellation (No School)

Cancellation will be called no later than 6:00am. If a late start has already been called and the weather conditions continue to deteriorate, every effort will be made to call a cancellation prior to 7:00am.

Early Dismissal

- On a day when school is in session and the weather becomes questionable, parents should expect a Renweb Parent Alert call and can check with the ECA website for updates on school closures. An early dismissal, if called, will be called by 10:00am. Early dismissal means that classes at the Secondary campus will end at 11:30am and that the Elementary campus will close by 12:00 noon.
- Parents should review the procedures with their children to make sure they know what to do and where to go if school is dismissed early or if the weather looks bad for the day. It is very important to listen to the radio, TV, or check the above website on stormy days.
- If the parent is concerned about the weather conditions, students may be picked up at any time. Secondary students who drive to and from school may be excused to leave school at any time only if the parent has phoned the school office to request the departure.

Secondary

- A student driver should have clear directions from his/her parents as to whether he/she should drive in poor weather conditions.

TRAFFIC PATTERNS (see maps below)

From 7:30-7:55am, all vehicles are required to enter the campus from North Carefree Circle and exit onto Nonchalant Circle South or return to North Carefree Circle. It is of utmost importance that no one enters the campus from Nonchalant Circle South during these times. When dropping off your student, pull forward as far as possible before allowing your student to exit the vehicle and do not enter the ramp. High School students arriving before 7:50am are to wait quietly *by their lockers or in the hallway*. Junior High students dropped off before 7:50 am, should wait in Room 115 (Lunchroom) until dismissed to go to their lockers.

From 2:45--3:15 pm. All vehicles picking up High School students or Junior High students with High School siblings are required to enter the campus from North Carefree Circle and exit by returning to North Carefree Circle. When picking up students, form a single-file line along the building and do not enter the ramp. *All* students waiting to be picked up are to wait *only* on the ramp, in the airlock by the office entrance, or on the chairs by the school office. Students are not permitted to wait by the church youth offices; parents are not to wait in that area either.

From 2:45--3:15 pm: All vehicles picking up ONLY Junior High students should enter and exit off Nonchalant Circle South. Students will be picked up in the ½ circle by the lower gym entrance. Junior High students picked up at the lower gym entrance should wait in the area outside the library until their ride arrives.

Evangelical Christian Academy

Secondary Campus Drop-Off Plan (7:30 AM – 7:55 AM)



All Students
Drop-Off
Location

Drop-Off
route is in
orange

Please do not enter the ramp near the front ECA entrance (orange star). The ramp is for the shuttle only.

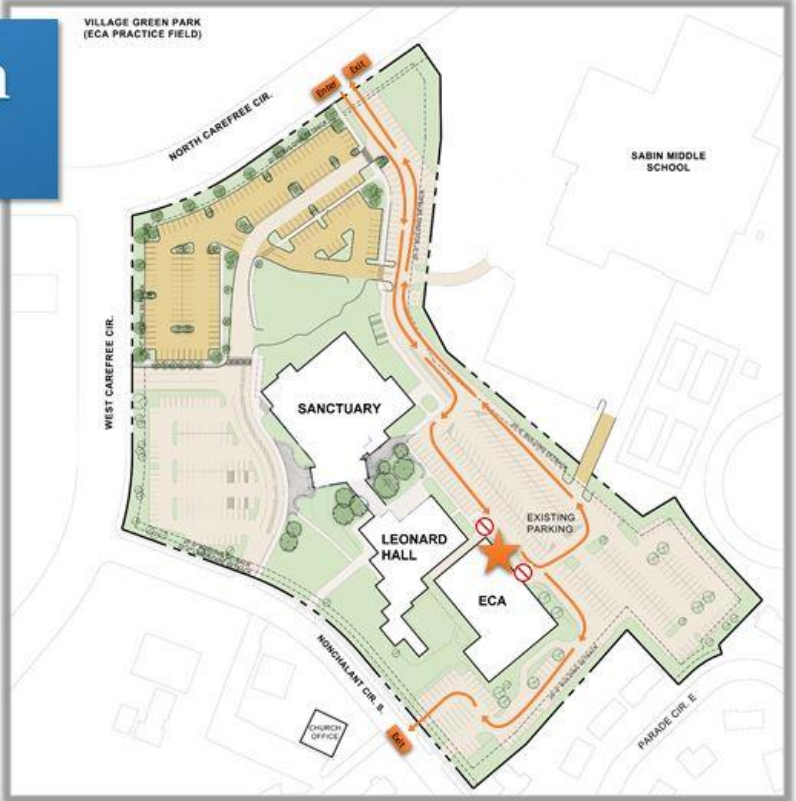

Evangelical Christian Academy

Secondary Campus Pick-Up Plan (2:45 PM – 3:15 PM)



Senior High
Pick-Up
Location

Senior High
route is in
orange



Junior High
Pick-Up
Location

Junior High
route is in
blue

If you have children in both senior high and junior high, please use the senior high pick-up location.

Please do not enter the ramp near the front ECA entrance (orange star). The ramp is for the shuttle only.

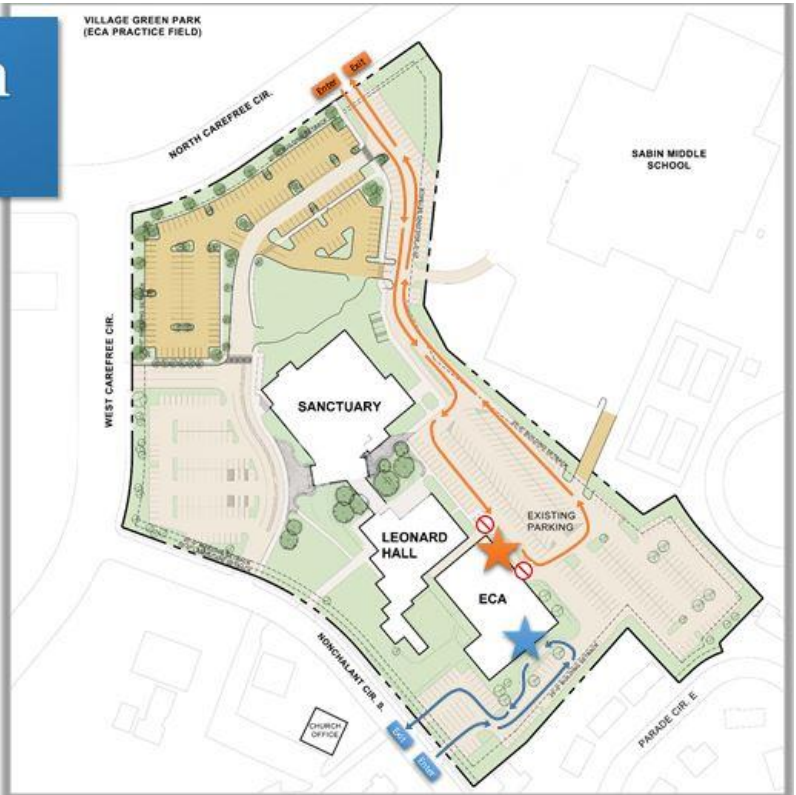

At no time should any vehicle be parked in the **shuttle loading zone marked "no parking"** - to do so jeopardizes student safety. Drivers may not leave their vehicles unattended in the drop-off/pick-up line; parents who must exit their vehicles to enter the building must park in *designated parking spaces only*.